

AIROBOT S2



SLS Horsham
The Barn
25 St Leonards Road
Horsham
West Sussex
RH13 6EH

07733 150003
07917 300500

Indian Ocean MVHR Ltd
Unit 13
Socota Phoenicia
Sayed Hossen Road
Phoenix
73408



As standard equipment, includes:

- integrated CO₂, VOC, air temperature and humidity sensors
- autonomous control – smart control of fans ensures high-quality interior climate
- room occupancy sensing (together with energy saving mode)
- humidity detection mode.

Specifications

Installation	wall-mounted, vertically
Airflow up to	Airobot S2 / S2 ERV: 500 m ³ /h or 139 l/s or 250 m ² ventilated area
Heat exchanger	HRV: plate heat exchanger with heat recovery ERV: plate heat exchanger with humidity and heat recovery
Heat recovery efficiency	S2: 92.2%, S2 ERV: 85.1%
Filters	panel filters, ePM10 55% (M5) / outside air ePM10 55% (M5)
Power supply	1–230 VAC 50 Hz
Maximum power	2.2 kW (16 A)
Motors	2 × 163 W EC
Preheater (frost protection)	integrated, nominal power 1.35 kW PTC, 0–100% control
Special power SPI (S2 / S2 ERV)	0.37 / 0.37 W/(m ³ /h) ^{277 m³/h / 50 Pa}
Special power SFP (S2 / S2 ERV)	1.33 / 1.33 W/(m ³ /s) ^{277 m³/h / 50 Pa}
Condensate connection (mm)	32 mm
Colours	white, black
Packaging	60 × 80 × 131 cm, weight 60 kg

Energy labels

Airobot S2

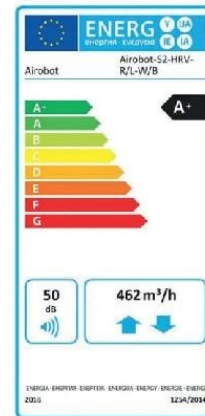

Airobot S2 ERV

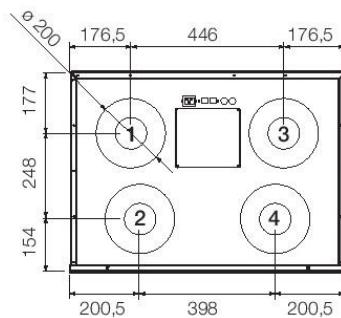
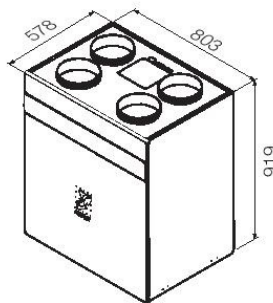
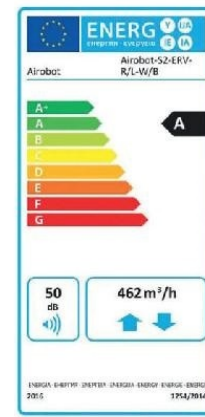

Ducts

Type R

1. Supply air
2. Extract air
3. Exhaust air
4. Outside air

Type L

1. Exhaust air
2. Outside air
3. Supply air
4. Extract air